

Exhibit A-3
Project ITB-DH-2017-04

NORTH OVERFLOW CHANNEL

Project No.: ITB-DH-2017-04

ADDENDUM #2 – April 11, 2017

Please find below a list of clarifications for consideration in preparing the bid for this project:

1. Wage Decision:
Use attached updated Wage Decision dated 4-7-17.
2. Bid bond:
Per Addendum #1, Item #2, Bid Bond value shall be 5% of the Bid price. Delete previously provided Town Bid Bond form and replace with the attached Bid Bond form (revised to reflect 5%).
3. Plan Sheets:
4. Add attached Plan Sheets 6.02 & 6.03 to the plan set. Sheet 6.02 includes profile and cross-section details of the 5 rip-rap Grade Control Structures, the rip-rap Channel Crest (inlet) Structure, and the rip-rap Channel Toe (outlet) Structure. Sheet 6.03 includes Temporary Erosion Control BMP typical details for use on this project. No changes have been made to Plan Sheets 6.00 & 6.01
5. Bid Award:
The anticipated award date for this project is May 2, 2017, following the Board of Trustees meeting on May 1, 2017.
6. Topsoil:
See Addendum #1, Items #4 & #5.
7. Controlling Water:
See Addendum #1, Item #12.
8. Permits:
The only permits required are listed in the Special Provisions, Item #18.
9. Surveyor working on the Bohn Park Project:
Azimuth Surveying.

Acknowledged Addendum #2:

Contractor

By (printed)

By (signed)

Date

General Decision Number: C0170012 04/07/2017 C012

Superseded General Decision Number: C020160012

State: Colorado

Construction Type: Heavy

Counties: Adams, Arapahoe, Boulder, Broomfield, Denver, Douglas, El Paso, Jefferson, Larimer, Mesa, Pueblo and Weld Counties in Colorado.

HEAVY CONSTRUCTION PROJECTS

Note: Under Executive Order (EO) 13658, an hourly minimum wage of \$10.20 for calendar year 2017 applies to all contracts subject to the Davis-Bacon Act for which the contract is awarded (and any solicitation was issued) on or after January 1, 2015. If this contract is covered by the EO, the contractor must pay all workers in any classification listed on this wage determination at least \$10.20 (or the applicable wage rate listed on this wage determination, if it is higher) for all hours spent performing on the contract in calendar year 2017. The EO minimum wage rate will be adjusted annually. Additional information on contractor requirements and worker protections under the EO is available at www.dol.gov/whd/govcontracts.

Modification Number	Publication Date
0	01/06/2017
1	01/20/2017
2	02/03/2017
3	04/07/2017

ASBE0028-001 07/01/2016

	Rates	Fringes
--	-------	---------

Asbestos Workers/Insulator (Includes application of all insulating materials, protective coverings, coatings and finishings to all types of mechanical systems).....	\$ 29.73	13.93
--	----------	-------

BRC0007-004 01/01/2017

ADAMS, ARAPAHOE, BOULDER, BROOMFIELD, DENVER, DOUGLAS AND JEFFERSON COUNTIES

	Rates	Fringes
--	-------	---------

BRICKLAYER.....	\$ 26.62	7.99
-----------------	----------	------

BRC0007-006 05/01/2016

EL PASO AND PUEBLO COUNTIES

	Rates	Fringes
--	-------	---------

BRICKLAYER.....	\$ 24.95	9.39
-----------------	----------	------

 ELEC0012-004 09/01/2016

PUEBLO COUNTY

	Rates	Fringes
ELECTRICIAN		
Electrical contract over		
\$1,000,000.....	\$ 28.00	11.00+3%
Electrical contract under		
\$1,000,000.....	\$ 24.85	11.00+3%

ELEC0068-001 01/01/2017

ADAMS, ARAPAHOE, BOULDER, BROOMFIELD, DENVER, DOUGLAS,
 JEFFERSON, LARIMER, AND WELD COUNTIES

	Rates	Fringes
ELECTRICIAN.....	\$ 33.85	14.09

ELEC0111-001 01/01/2016

	Rates	Fringes
Line Construction:		
Groundman.....	\$ 18.79	22.25%+\$5.45
Line Equipment Operator.....	\$ 29.40	22.25%+\$5.45
Lineman and Welder.....	\$ 42.14	25.25%+\$5.45

ELEC0113-002 06/01/2015

EL PASO COUNTY

	Rates	Fringes
ELECTRICIAN.....	\$ 30.00	14.95

ELEC0969-002 06/01/2015

MESA COUNTY

	Rates	Fringes
ELECTRICIAN.....	\$ 24.00	7.92

ENGI0009-001 10/23/2013

	Rates	Fringes
Power equipment operators:		
Blade: Finish.....	\$ 25.04	9.15
Blade: Rough.....	\$ 24.73	9.15
Bulldozer.....	\$ 24.73	9.15
Cranes: 50 tons and under..	\$ 24.88	9.15
Cranes: 51 to 90 tons.....	\$ 25.04	9.15
Cranes: 91 to 140 tons.....	\$ 25.19	9.15
Cranes: 141 tons and over..	\$ 25.97	9.15
Forklift.....	\$ 24.37	9.15
Mechanic.....	\$ 24.88	9.15
Oiler.....	\$ 24.01	9.15
Scraper: Single bowl		
under 40 cubic yards.....	\$ 24.88	9.15

Scrapers: Single bowl,
including pups 40 cubic
yards and over and tandem
bowls.....\$ 25.04 9.15
Trackhoe.....\$ 24.88 9.15

* IRON0024-003 01/01/2017

	Rates	Fringes
Ironworkers:.....	\$ 26.05	21.20
Structural		

LAB00086-001 05/01/2009

	Rates	Fringes
Laborers:		
Pipelayer.....	\$ 18.68	6.78

PLUM0003-005 06/01/2016

ADAMS, ARAPAHOE, BOULDER, BROOMFIELD, DENVER, DOUGLAS,
JEFFERSON, LARIMER AND WELD COUNTIES

	Rates	Fringes
PLUMBER.....	\$ 38.43	15.19

PLUM0058-002 07/01/2016

EL PASO COUNTY

	Rates	Fringes
Plumbers and Pipefitters.....	\$ 35.60	13.65

PLUM0058-008 07/01/2016

PUEBLO COUNTY

	Rates	Fringes
Plumbers and Pipefitters.....	\$ 35.60	13.65

PLUM0145-002 07/01/2016

MESA COUNTY

	Rates	Fringes
Plumbers and Pipefitters.....	\$ 35.17	11.70

PLUM0208-004 06/01/2015

ADAMS, ARAPAHOE, BOULDER, BROOMFIELD, DENVER, DOUGLAS,
JEFFERSON, LARIMER AND WELD COUNTIES

	Rates	Fringes
PIPEFITTER.....	\$ 35.35	13.39

SHEE0009-002 07/01/2016

	Rates	Fringes
Sheet metal worker.....	\$ 32.56	15.96

TEAM0455-002 07/01/2015		

	Rates	Fringes
Truck drivers:		
Pickup.....	\$ 19.66	4.02
Tandem/Semi and Water.....	\$ 20.29	4.02

SUC02001-006 12/20/2001		

	Rates	Fringes
BOILERMAKER.....	\$ 17.60	
Carpenters:		
Form Building and Setting...	\$ 16.97	2.74
All Other Work.....	\$ 15.14	3.37
Cement Mason/Concrete Finisher...	\$ 17.31	2.85
IRONWORKER, REINFORCING.....	\$ 18.83	3.90
Laborers:		
Common.....	\$ 11.22	2.92
Flagger.....	\$ 8.91	3.80
Landscape.....	\$ 12.56	3.21
Painters:		
Brush, Roller & Spray.....	\$ 15.81	3.26
Power equipment operators:		
Backhoe.....	\$ 16.36	2.48
Front End Loader.....	\$ 17.24	3.23
Skid Loader.....	\$ 15.37	4.41

WELDERS - Receive rate prescribed for craft performing operation to which welding is incidental.

=====

Note: Executive Order (EO) 13706, Establishing Paid Sick Leave for Federal Contractors applies to all contracts subject to the Davis-Bacon Act for which the contract is awarded (and any solicitation was issued) on or after January 1, 2017. If this contract is covered by the EO, the contractor must provide employees with 1 hour of paid sick leave for every 30 hours they work, up to 56 hours of paid sick leave each year. Employees must be permitted to use paid sick leave for their own illness, injury or other health-related needs, including preventive care; to assist a family member (or person who is like family to the employee) who is ill, injured, or has other health-related needs, including preventive care; or for reasons resulting from, or to assist a family member (or person who is like family to the employee) who is a victim of, domestic violence, sexual assault, or stalking. Additional information on contractor requirements and worker protections under the EO is available at www.dol.gov/whd/govcontracts.

Unlisted classifications needed for work not included within

the scope of the classifications listed may be added after award only as provided in the labor standards contract clauses (29CFR 5.5 (a) (1) (ii)).

The body of each wage determination lists the classification and wage rates that have been found to be prevailing for the cited type(s) of construction in the area covered by the wage determination. The classifications are listed in alphabetical order of "identifiers" that indicate whether the particular rate is a union rate (current union negotiated rate for local), a survey rate (weighted average rate) or a union average rate (weighted union average rate).

Union Rate Identifiers

A four letter classification abbreviation identifier enclosed in dotted lines beginning with characters other than "SU" or "UAVG" denotes that the union classification and rate were prevailing for that classification in the survey. Example: PLUM0198-005 07/01/2014. PLUM is an abbreviation identifier of the union which prevailed in the survey for this classification, which in this example would be Plumbers. 0198 indicates the local union number or district council number where applicable, i.e., Plumbers Local 0198. The next number, 005 in the example, is an internal number used in processing the wage determination. 07/01/2014 is the effective date of the most current negotiated rate, which in this example is July 1, 2014.

Union prevailing wage rates are updated to reflect all rate changes in the collective bargaining agreement (CBA) governing this classification and rate.

Survey Rate Identifiers

Classifications listed under the "SU" identifier indicate that no one rate prevailed for this classification in the survey and the published rate is derived by computing a weighted average rate based on all the rates reported in the survey for that classification. As this weighted average rate includes all rates reported in the survey, it may include both union and non-union rates. Example: SULA2012-007 5/13/2014. SU indicates the rates are survey rates based on a weighted average calculation of rates and are not majority rates. LA indicates the State of Louisiana. 2012 is the year of survey on which these classifications and rates are based. The next number, 007 in the example, is an internal number used in producing the wage determination. 5/13/2014 indicates the survey completion date for the classifications and rates under that identifier.

Survey wage rates are not updated and remain in effect until a new survey is conducted.

Union Average Rate Identifiers

Classification(s) listed under the UAVG identifier indicate that no single majority rate prevailed for those classifications; however, 100% of the data reported for the classifications was union data. EXAMPLE: UAVG-OH-0010 08/29/2014. UAVG indicates that the rate is a weighted union average rate. OH indicates the state. The next number, 0010 in

the example, is an internal number used in producing the wage determination. 08/29/2014 indicates the survey completion date for the classifications and rates under that identifier.

A UAVG rate will be updated once a year, usually in January of each year, to reflect a weighted average of the current negotiated/CBA rate of the union locals from which the rate is based.

WAGE DETERMINATION APPEALS PROCESS

1.) Has there been an initial decision in the matter? This can be:

- * an existing published wage determination
- * a survey underlying a wage determination
- * a Wage and Hour Division letter setting forth a position on a wage determination matter
- * a conformance (additional classification and rate) ruling

On survey related matters, initial contact, including requests for summaries of surveys, should be with the Wage and Hour Regional Office for the area in which the survey was conducted because those Regional Offices have responsibility for the Davis-Bacon survey program. If the response from this initial contact is not satisfactory, then the process described in 2.) and 3.) should be followed.

With regard to any other matter not yet ripe for the formal process described here, initial contact should be with the Branch of Construction Wage Determinations. Write to:

Branch of Construction Wage Determinations
Wage and Hour Division
U.S. Department of Labor
200 Constitution Avenue, N.W.
Washington, DC 20210

2.) If the answer to the question in 1.) is yes, then an interested party (those affected by the action) can request review and reconsideration from the Wage and Hour Administrator (See 29 CFR Part 1.8 and 29 CFR Part 7). Write to:

Wage and Hour Administrator
U.S. Department of Labor
200 Constitution Avenue, N.W.
Washington, DC 20210

The request should be accompanied by a full statement of the interested party's position and by any information (wage payment data, project description, area practice material, etc.) that the requestor considers relevant to the issue.

3.) If the decision of the Administrator is not favorable, an interested party may appeal directly to the Administrative Review Board (formerly the Wage Appeals Board). Write to:

Administrative Review Board
U.S. Department of Labor
200 Constitution Avenue, N.W.
Washington, DC 20210

4.) All decisions by the Administrative Review Board are final.

=====

END OF GENERAL DECISION

BID BOND

KNOW ALL MEN BY THESE PRESENTS, that _____ as Principal, and as Surety, are hereby held and firmly bound unto the Town of Lyons, Colorado (hereinafter called the "Owner") in the penal sum of _____ Dollars

(Written)

(\$ _____), lawful money of the United States of America, for the payment of which sum well and truly to be made, we bind ourselves, our heirs, executors, administrators, successors and assigns, jointly and severally, firmly to these presents.

THE CONDITION OF THIS OBLIGATION IS SUCH, that whereas the Principal has submitted the accompanying Bid dated _____, 20____ for the:

North Overflow Channel Project

as set out in the accompanying Bid.

WHEREAS, the Town as required as a condition for receiving said Bid that the principal deposit with the Owner either a certified check equivalent to not less than five percent (5%) of the amount of said Bid or in lieu thereof furnish a Bid Bond for said amount conditioned such that in the event of failure to execute the proposed Contract for such construction if the Contract is to be awarded to him, that said sum be paid immediately to the Town as liquidated damages and not as a penalty for the principal's failure to perform.

NOW THEREFORE, if the principal shall, within the period specified therefore:

- A. On the attached prescribed forms presented to him for signature, enter into a written Contract with the Town in accordance with his Bid as accepted, and give a Performance Bond with good and sufficient sureties, as may be required upon the forms prescribed by the Owner for the faithful performance and the proper fulfillment of said Contract, or
- B. Withdraw said Bid within the time specified, or
- C. Pay to the Town the sum determined upon herein as liquidated damages, and not as a penalty, then this obligation shall be void and of no effect, otherwise to remain in full force and effect.

TN WITNESS WHEREOF, the above parties have executed this instrument under their several seals this _____ day of _____, 20____ the name and corporate seal of each corporate party being hereto affixed and these presents duly signed by its undersigned representative pursuant to authority of its governing board.

Principal: _____

Address: _____

ATTEST:

By: _____

Surety: _____

Address: _____

(Continues on Next Sheet)

INSTRUCTIONS

- 1.1 The full firm name and residence of each individual party to the bond must be inserted in the first paragraph.
- 1.2 If the principal is a partnership, the full name of all partners must be inserted in the first paragraph which must recite that they are partners composing the partnership (to be named), and all partners must execute the bond as individuals.
- 1.3 The state of incorporation of each corporate party to the bond must be inserted in the first paragraph and the bond must be executed under the corporate seal of said party attested by its secretary or other authorized officer.
- 1.4 Power of Attorney must accompany this bond when signed by other than an officer of either the principal or surety.
- 1.5 A standard printed bond form may be used in lieu of the foregoing form provided that the security stipulations protecting the Town are not in any way reduced by use of such standard printed bond form.

C:\USERS\SCOTT\DROPBOX (S2O DESIGN)\DOCUMENTS\LYONS\BOHN PARK RECOVERY DESIGN\DESIGN\WORKING DRAWINGS\NORTH OVERFLOW UPDATE.DWG

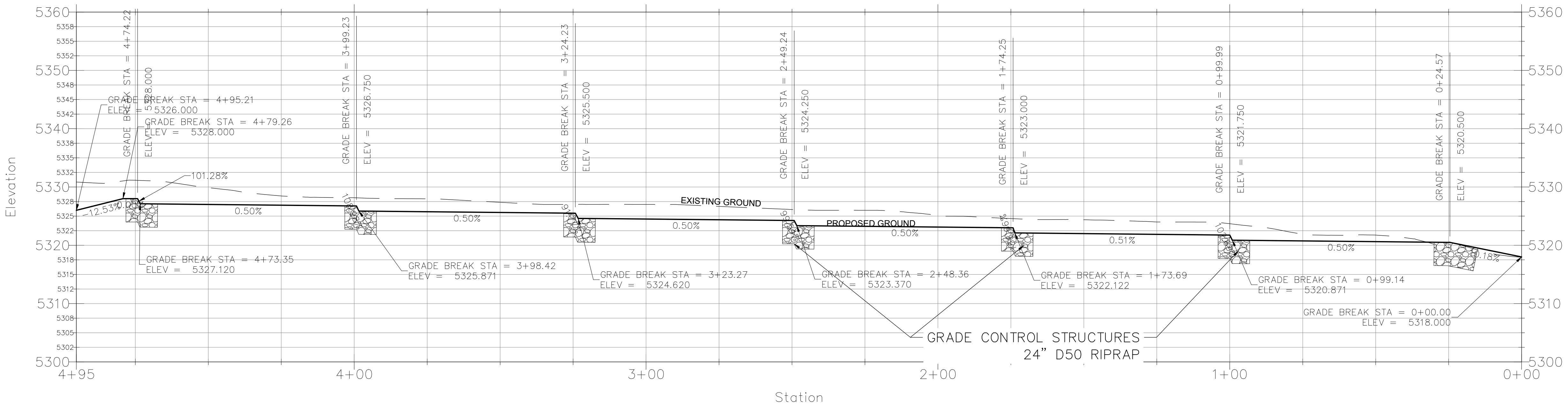
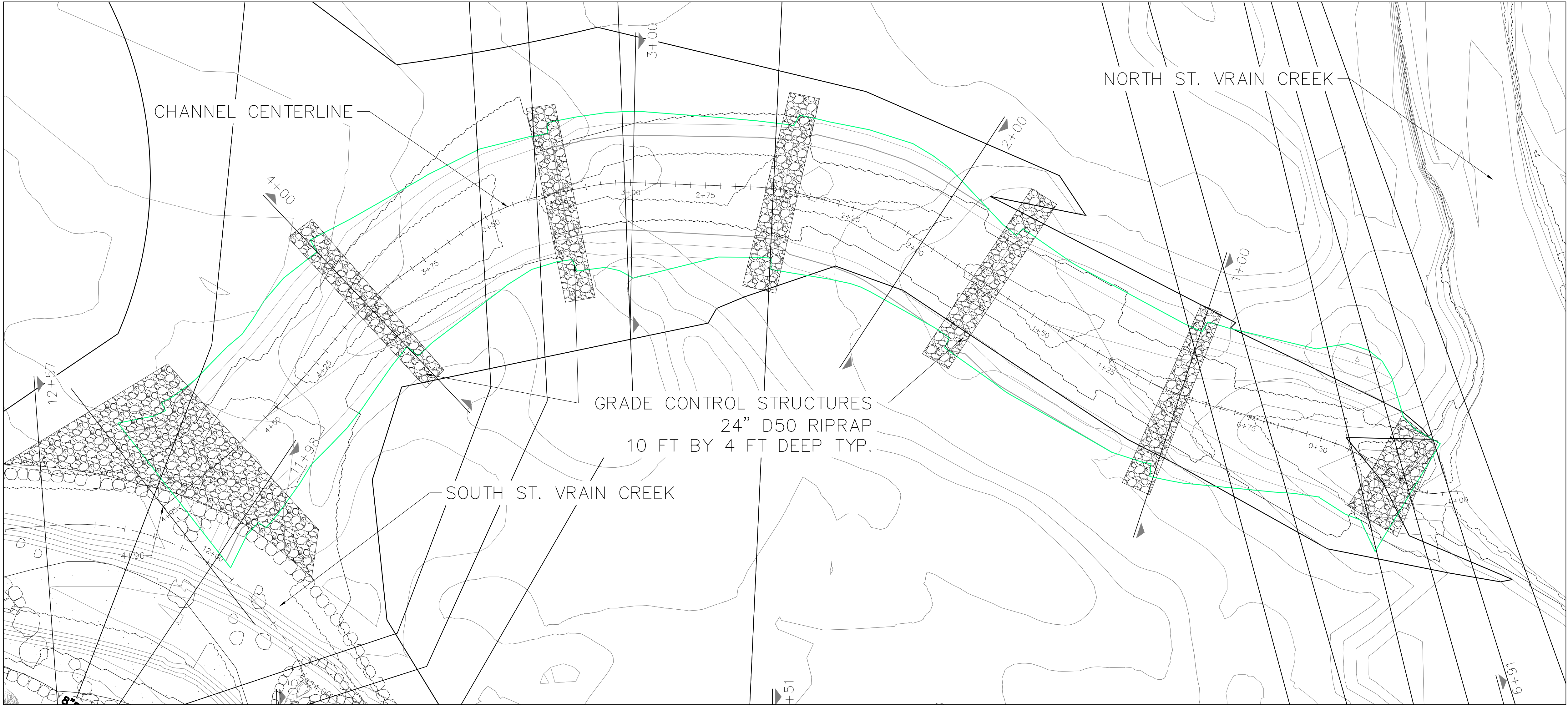

NORTH OVERFLOW CHANNEL PLAN AND PROFILE



S2O Design and Engineering

Scott Shipley, P.E.
318 McConnell Drive
Lyons CO, 80540,
USA
(303) 819-3985

Client:
TOWN OF LYONS



Project Name:
BOHN PARK NORTHERN OVERFLOW

Status:
CONSTRUCTION DRAWINGS

Drawing Name:
NORTH OVERFLOW CHANNEL PLAN AND PROFILE

Revisions:
--

Drawn By:
JR, NW, CC

Checked By:
Scott Shipley

Date:
03/01/2017

Stamp:

REUSE OF DOCUMENT:
THIS DOCUMENT IS THE PROPERTY OF S2O DESIGN AND ENGINEERING. THE IDEAS, DESIGN AND CONTENT INCORPORATED ON THIS DOCUMENT IS AN INSTRUMENT OF PROFESSIONAL SERVICE AND SHALL NOT BE USED FOR ANY OTHER PROJECT WITHOUT THE WRITTEN AUTHORIZATION OF S2O DESIGN AND ENGINEERING.

Scale:

Sheet:

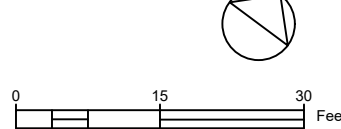

SR-6.00

C:\USERS\SCOTT\DROPBOX (S2O DESIGN)\DOCUMENTS\LYONS\BOHN PARK RECOVERY DESIGN\WORKING DRAWINGS\NORTH OVERFLOW UPDATE.DWG

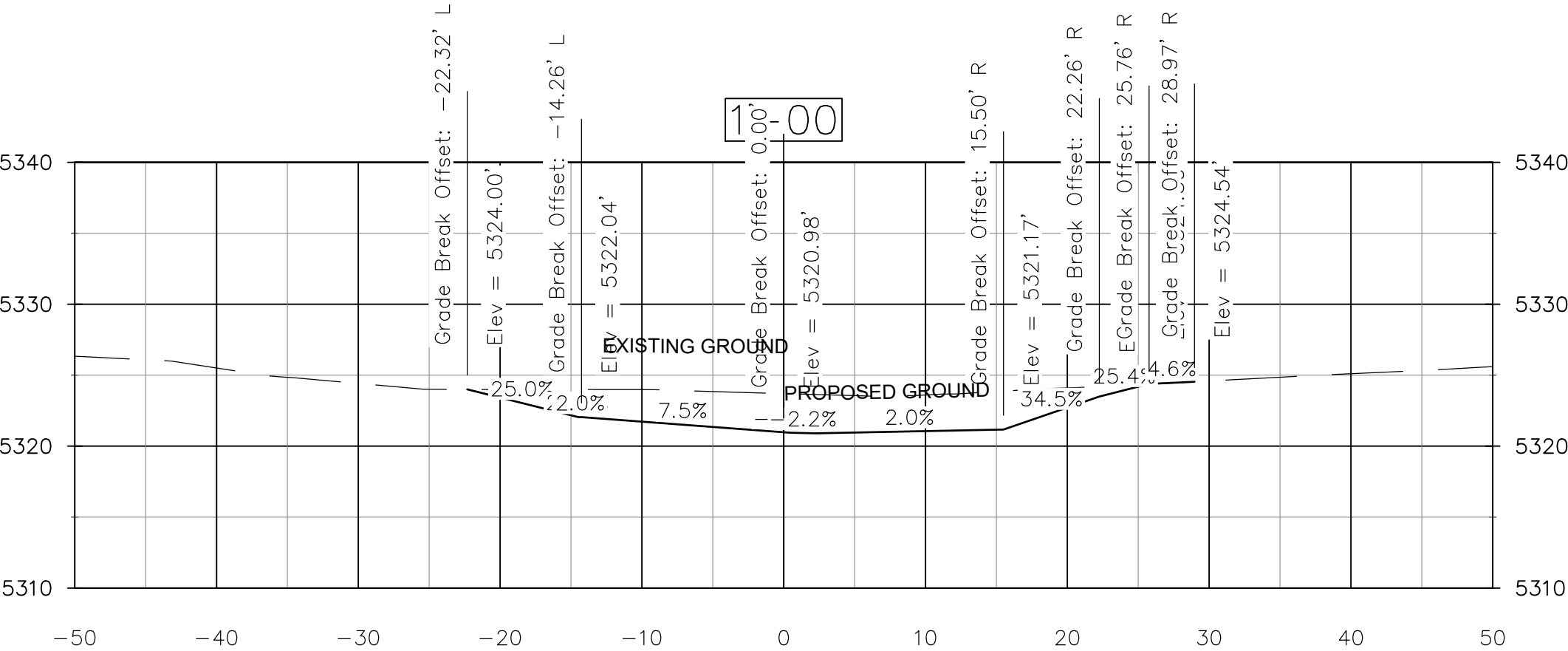
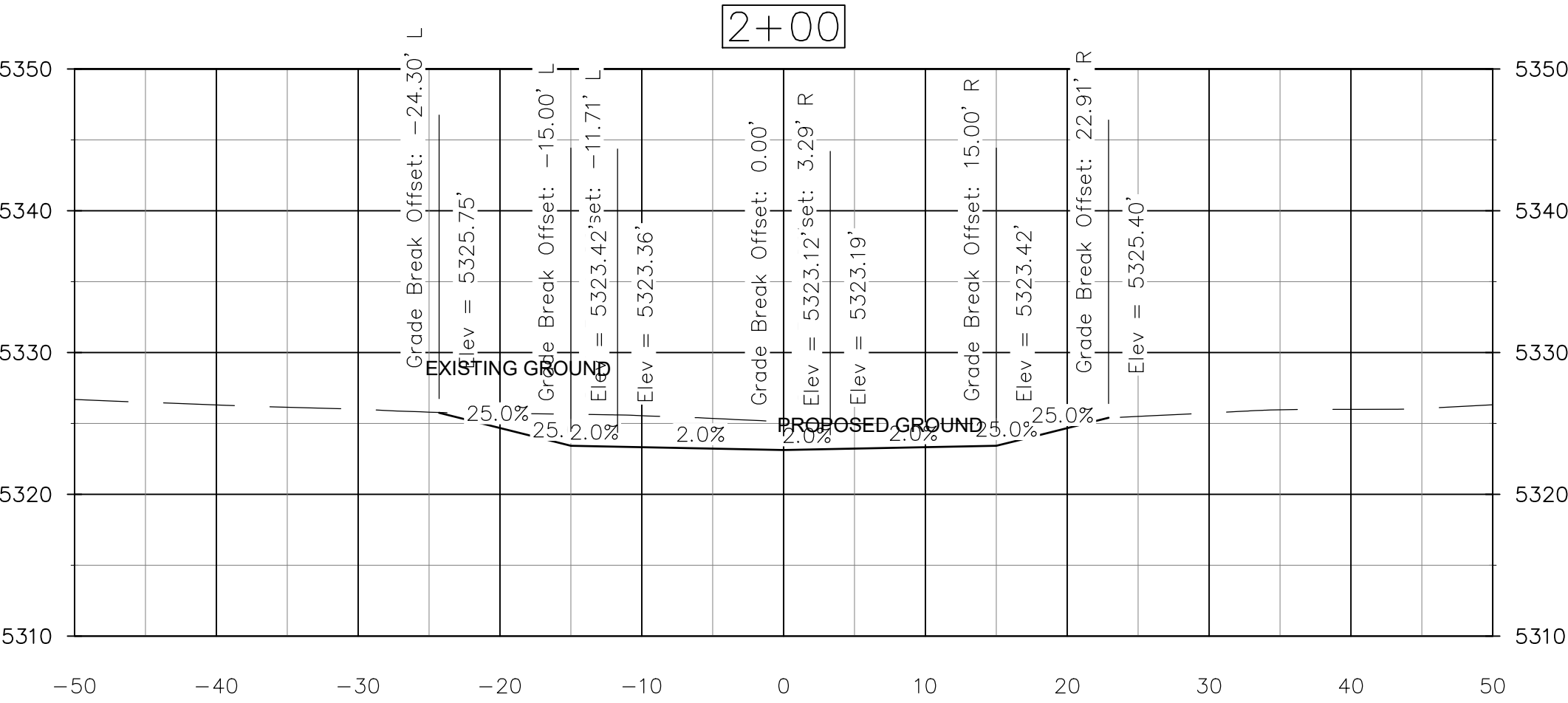
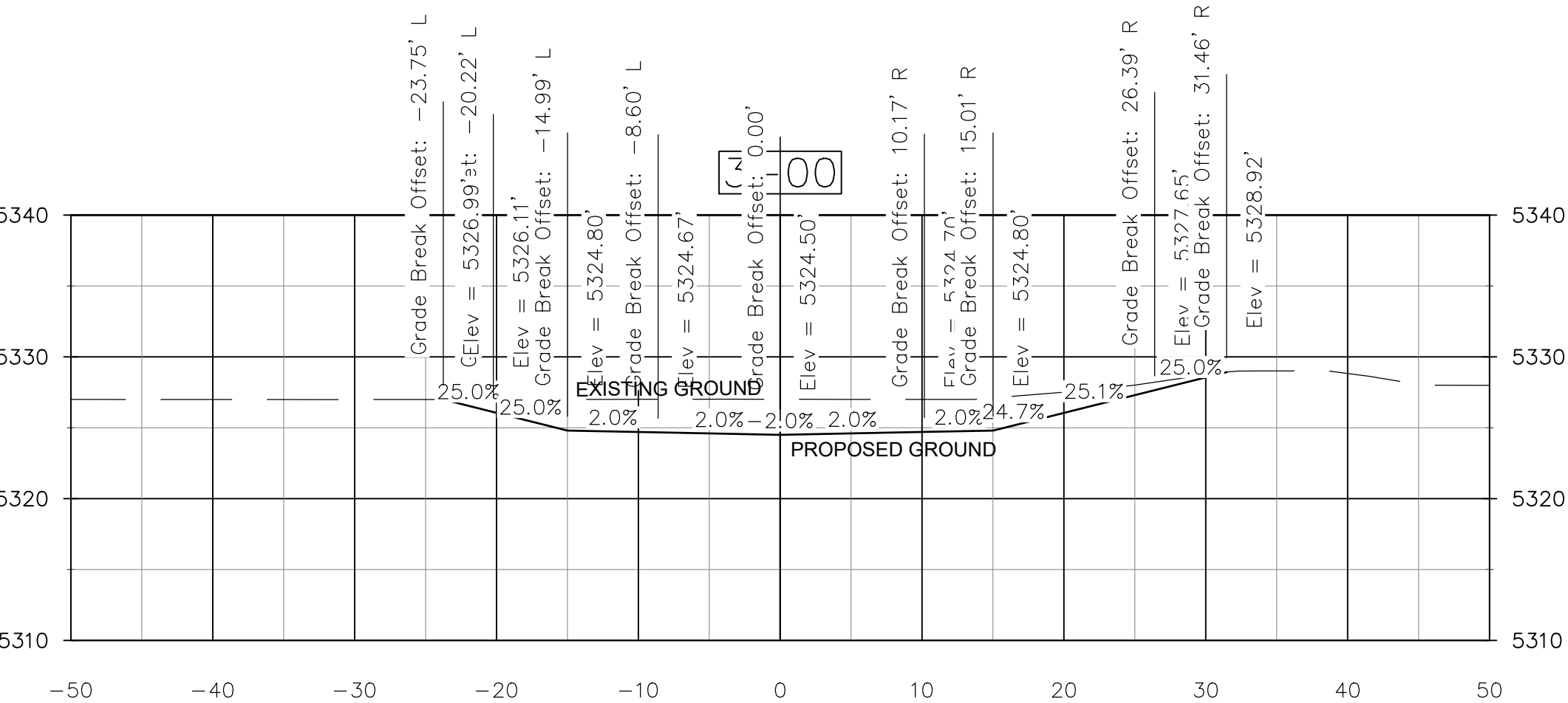
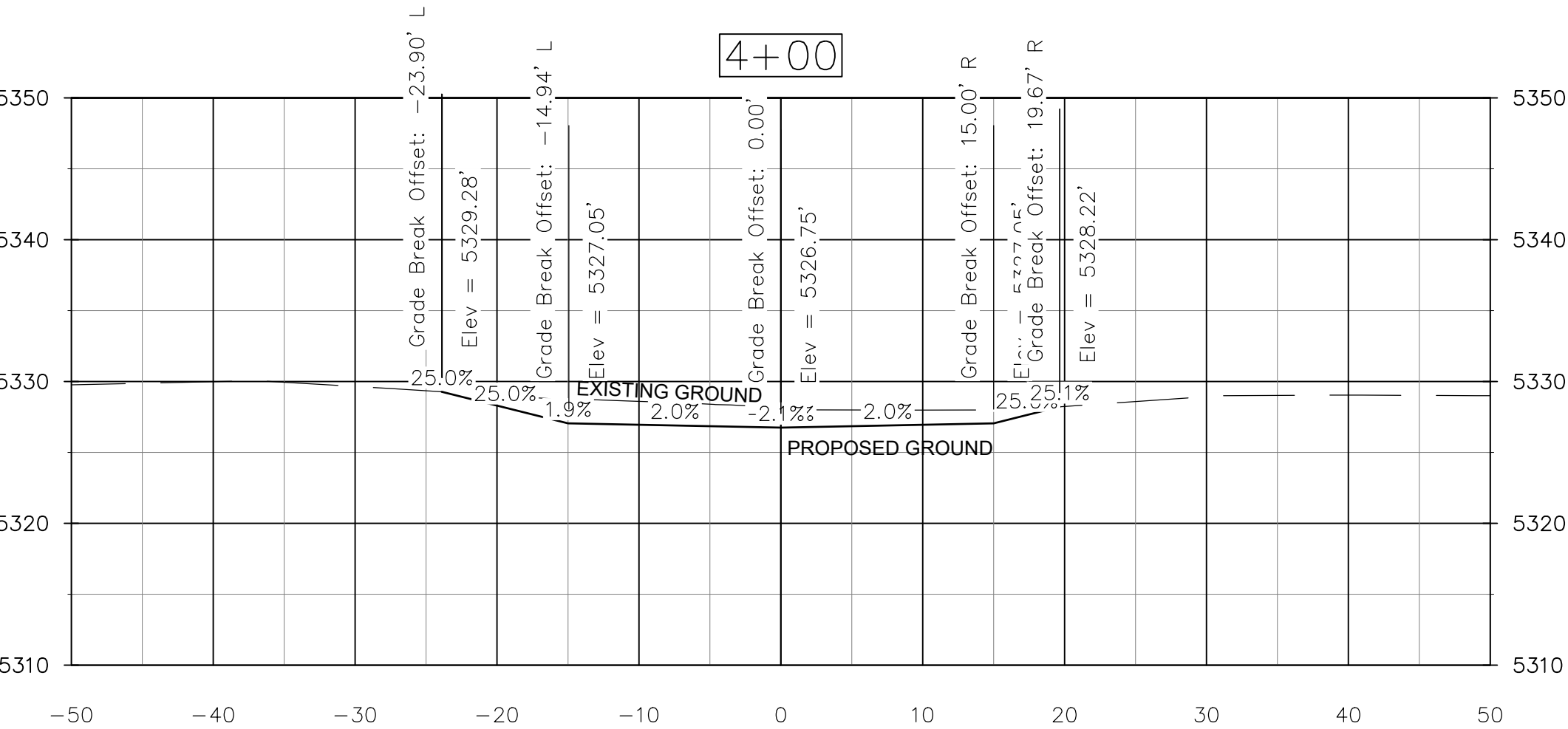

S2O Design and Engineering

Scott Shipley, P.E.
318 McConnell Drive
Lyons CO, 80540,
USA
(303) 819-3985

Client:

TOWN OF LYONS



Project Name:

BOHN PARK NORTHERN OVERFLOW

Status:

CONSTRUCTION DRAWINGS

Drawing Name:

NORTH OVERFLOW CHANNEL CROSS
SECTIONS

Revisions:

--

Drawn By:

JR, NW, CC

Checked By:

Scott Shipley

Date:

03/01/2017

Stamp:

REUSE OF DOCUMENT:
THIS DOCUMENT IS THE PROPERTY OF S2O DESIGN AND ENGINEERING. THE IDEAS, DESIGN
AND CONTENT INCORPORATED ON THIS DOCUMENT IS AN INSTRUMENT OF PROFESSIONAL
SERVICE AND SHALL NOT BE USED FOR ANY OTHER PROJECT WITHOUT THE WRITTEN
AUTHORIZATION OF S2O DESIGN AND ENGINEERING.

Scale:

Sheet:

SR-6.01

NORTH OVERFLOW CHANNEL CROSS SECTIONS

C:\USERS\SCOTT\DROPBOX (S2O DESIGN)\DOCUMENTS\LYONS\BOHN PARK RECOVERY DESIGN\DESIGN\WORKING DRAWINGS\NORTH OVERFLOW UPDATE.DWG

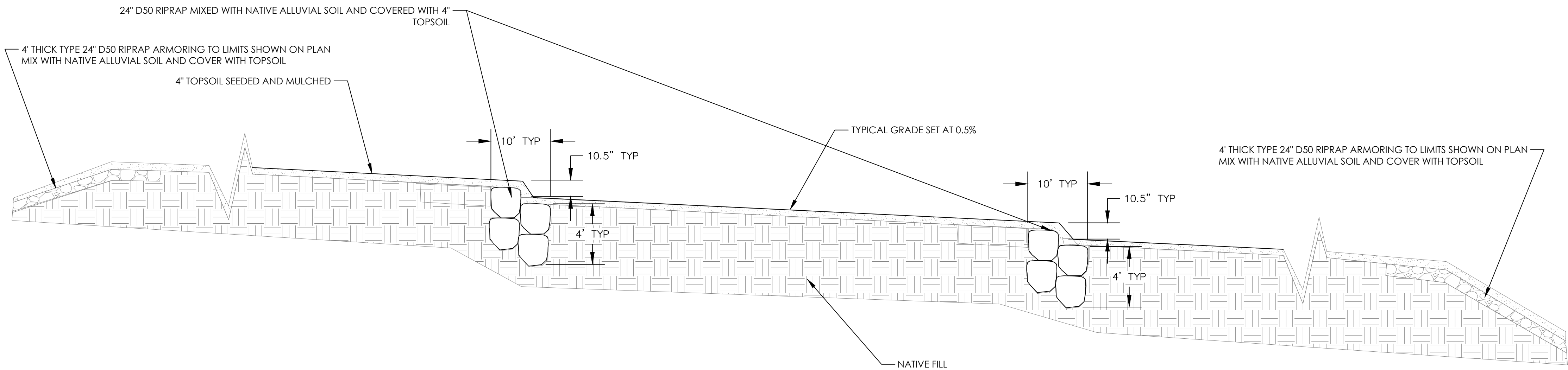

1 OVERFLOW CHANNEL DROP TYP. PROFILE SCALE: NOT TO SCALE

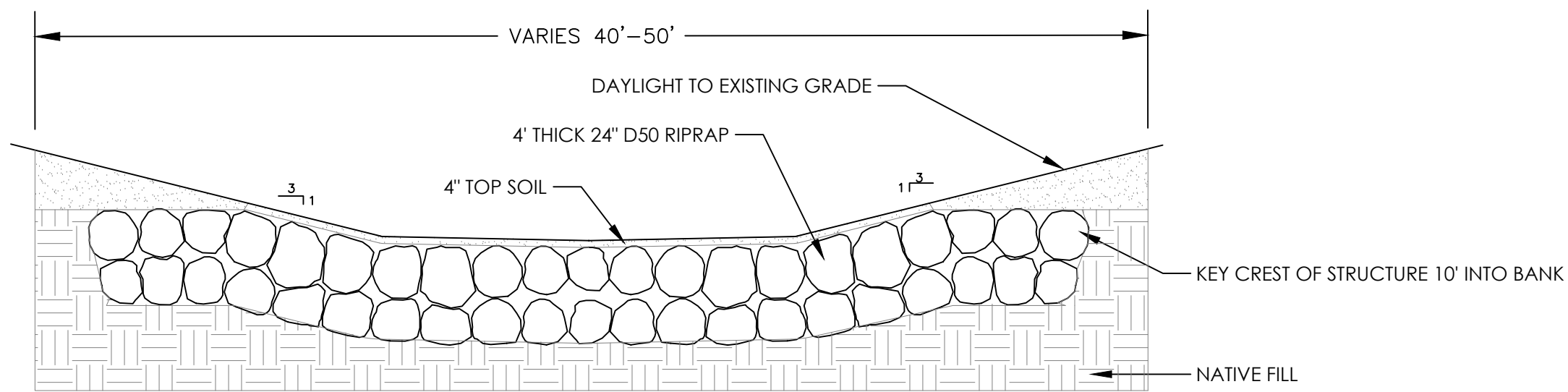

2 OVERFLOW CHANNEL DROP TYP. CROSS SECTION SCALE: 1:10



S2O Design and Engineering

Scott Shipley, P.E.
318 McConnell Drive
Lyons CO, 80540,
USA
(303) 819-3985

Client:
TOWN OF LYONS



Project Name:
BOHN PARK NORTHERN OVERFLOW

Status:
CONSTRUCTION DRAWINGS

Drawing Name:
**NORTH OVERFLOW CHANNEL TYPICAL
DETAILS**

Revisions:
--

Drawn By:
JR, NW, CC
Checked By:
Scott Shipley

Date:
03/01/2017

Stamp:

REUSE OF DOCUMENT:
THIS DOCUMENT IS THE PROPERTY OF S2O DESIGN AND ENGINEERING. THE IDEAS, DESIGN
AND CONTENT INCORPORATED ON THIS DOCUMENT IS AN INSTRUMENT OF PROFESSIONAL
SERVICE AND SHALL NOT BE USED FOR ANY OTHER PROJECT WITHOUT THE WRITTEN
AUTHORIZATION OF S2O DESIGN AND ENGINEERING.

Scale:

Sheet:

SR-6.02

NORTH OVERFLOW CHANNEL TYPICAL DETAILS

C:\USERS\SCOTT\DROPBOX (S2O DESIGN)\DOCUMENTS\WORKING DRAWINGS\NORTH OVERFLOW UPDATE.DWG

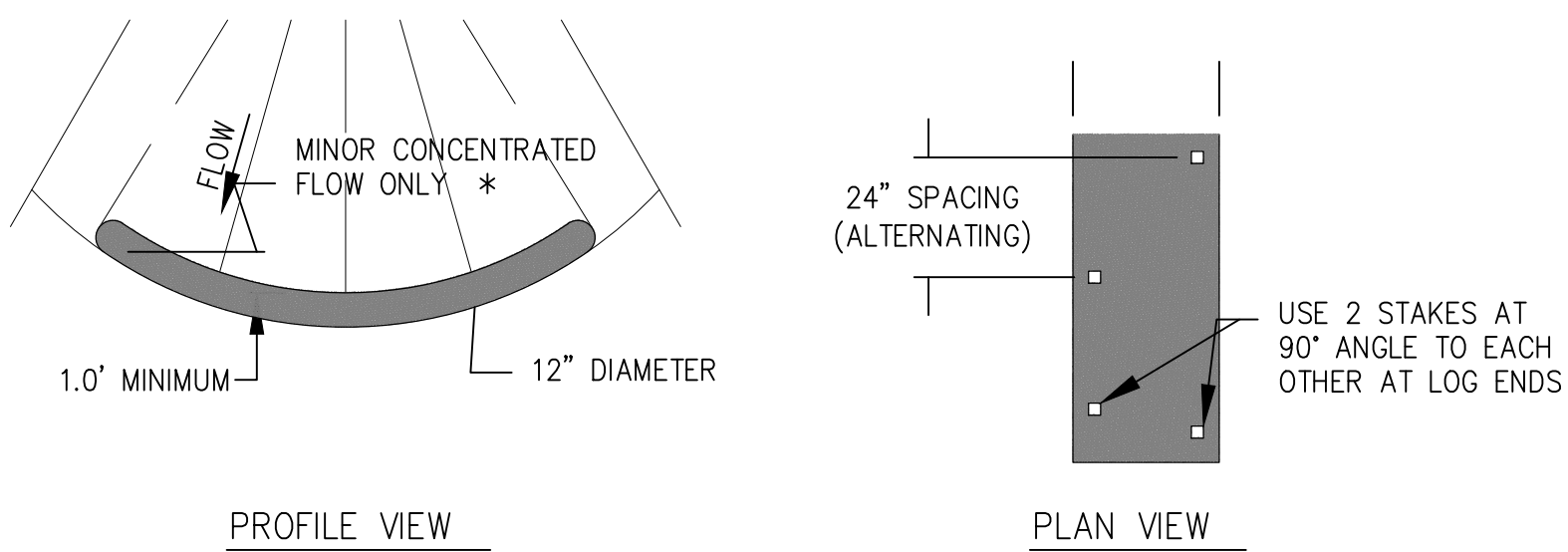
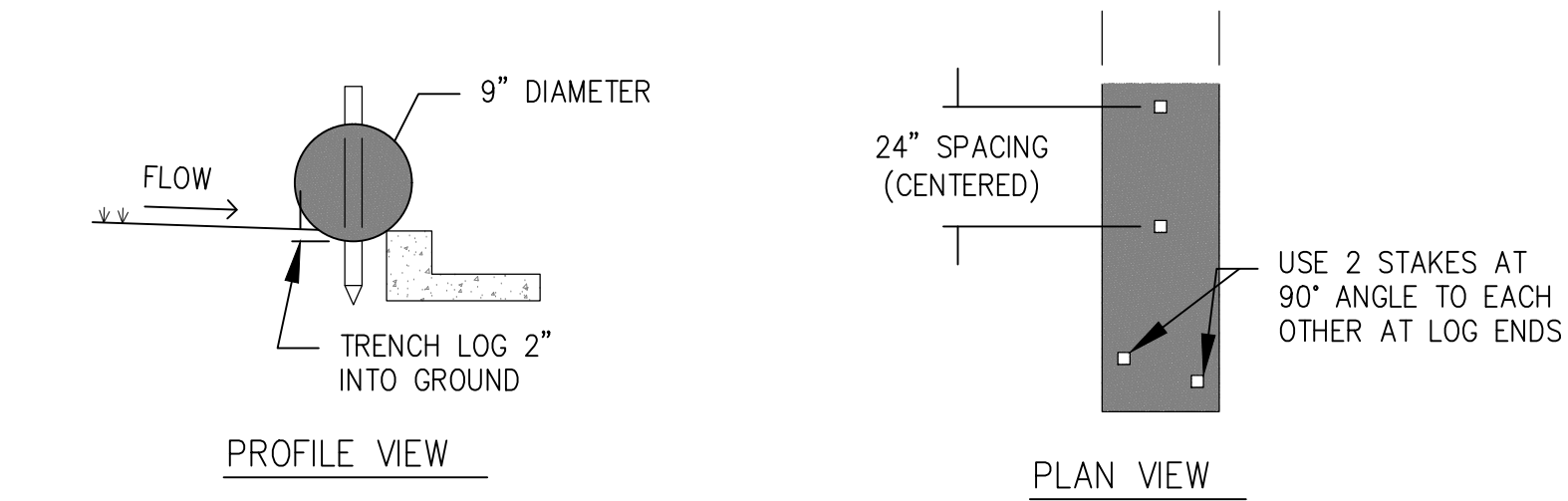
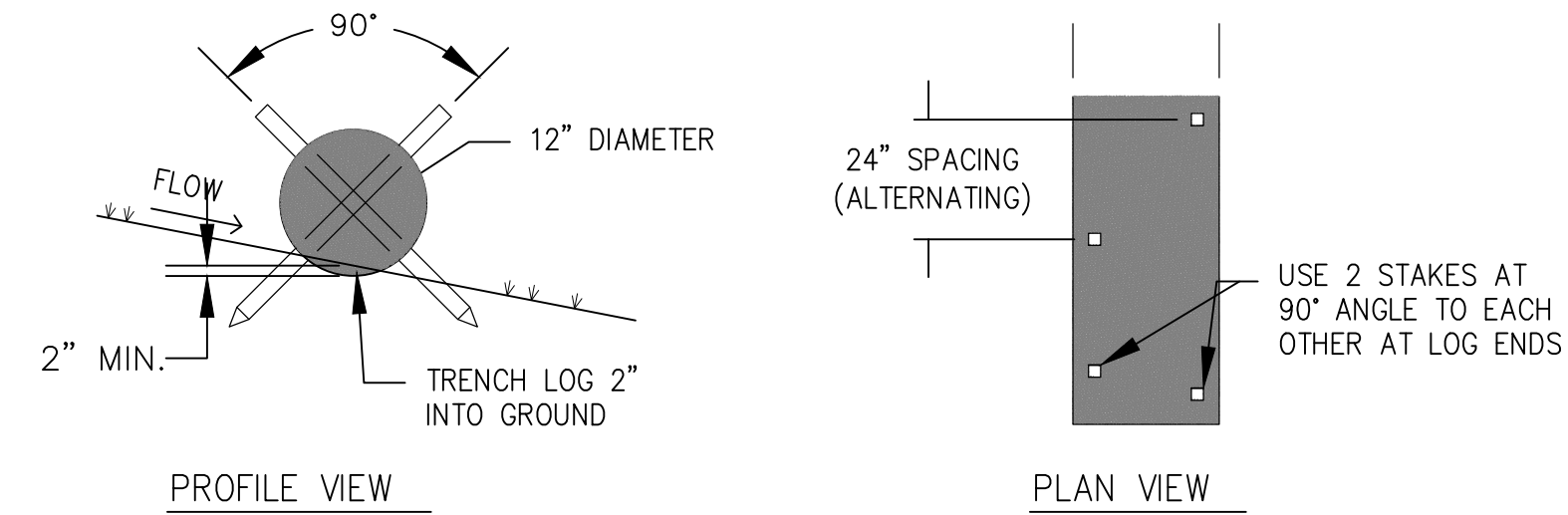

* FOR MAJOR CONCENTRATED FLOWS, USE A ROCK CHECK DAM

- NOTES:
- STAKES SHALL BE 1-1/2" x 1-1/2" x 24" MINIMUM AND EMBEDDED INTO GROUND A MINIMUM OF 12".
 - SEDIMENT CONTROL LOG SHALL BE TRENCHED 2" INTO GROUND.
 - FOR CONTINUOUS CONTROL, ADJACENT SEDIMENT CONTROL LOGS SHALL BE PLACED FIRMLY TOGETHER WITH NO GAPS.
 - SEDIMENT SHALL BE CLEANED/ REMOVED WHEN SEDIMENT DEPTH IS 1/2 THE HEIGHT OF THE SEDIMENT CONTROL LOG.

2 SEDIMENT CONTROL LOG
DETAILS NTS

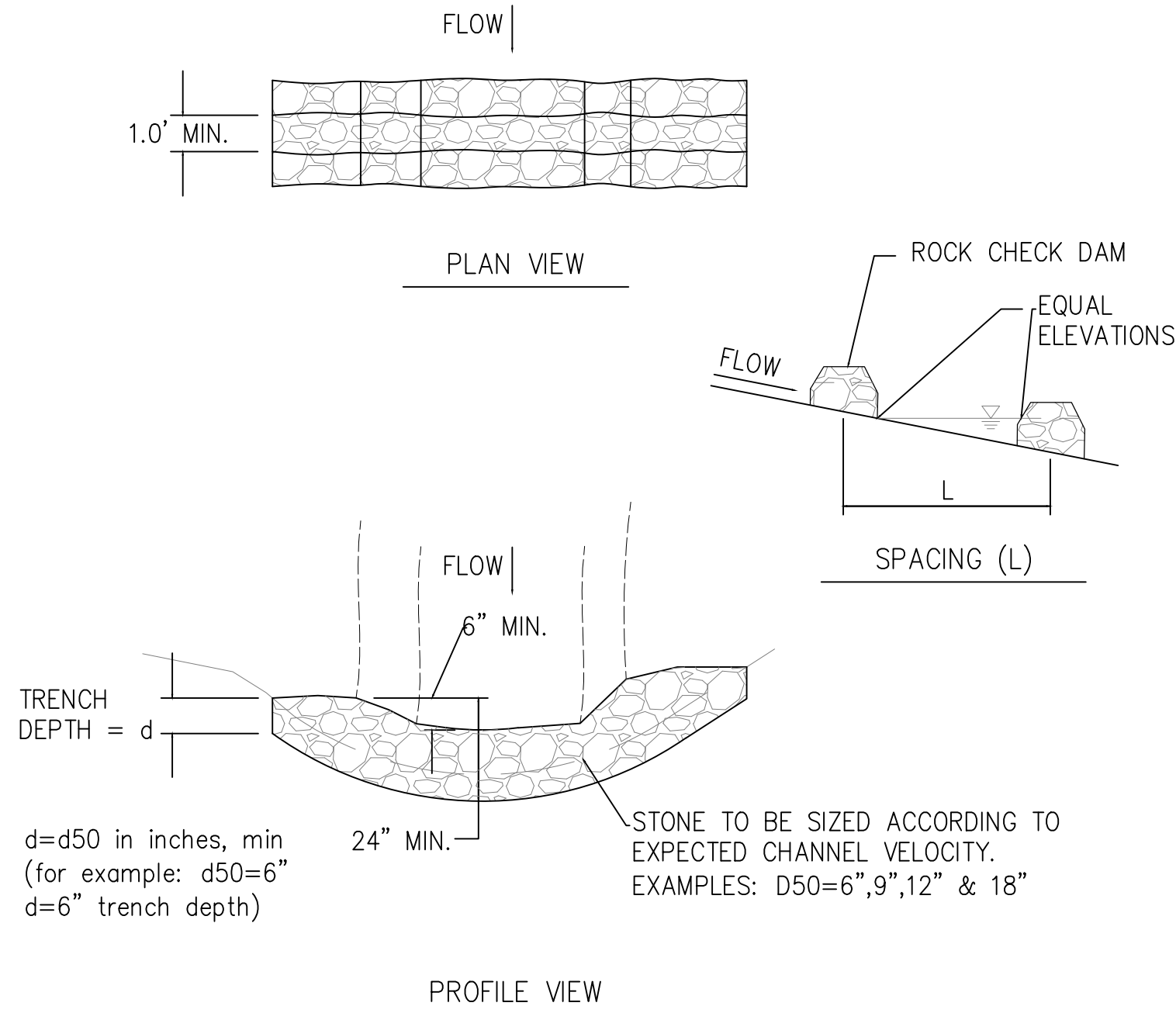

- NOTES:
- CHECK DAMS SHALL BE INSTALLED PRIOR TO UPSTREAM EARTH DISTURBING ACTIVITIES.
 - STONE SHALL HAVE < 10% FINES.
 - EACH END OF CHECK DAM SHALL BE 6" MINIMUM HIGHER THAN CENTER.
 - SEDIMENT SHALL BE REMOVED FROM THE CHECK DAM WHEN THE SEDIMENT DEPTH REACHES 1/2 THE HEIGHT OF THE CENTER.
 - CHECK DAM SHALL BE REMOVED ONCE ALL UPSTREAM DISTURBED AREAS HAVE BEEN STABILIZED.
 - UPON REMOVAL OF CHECK DAM, EXCAVATIONS SHALL BE FILLED WITH SUITABLE COMPACTED FILL, SEEDED AND COVERED WITH AN EROSION CONTROL BLANKET ADEQUATE FOR EXPECTED CHANNEL VELOCITY.

4 CHECK DAM
DETAILS NTS

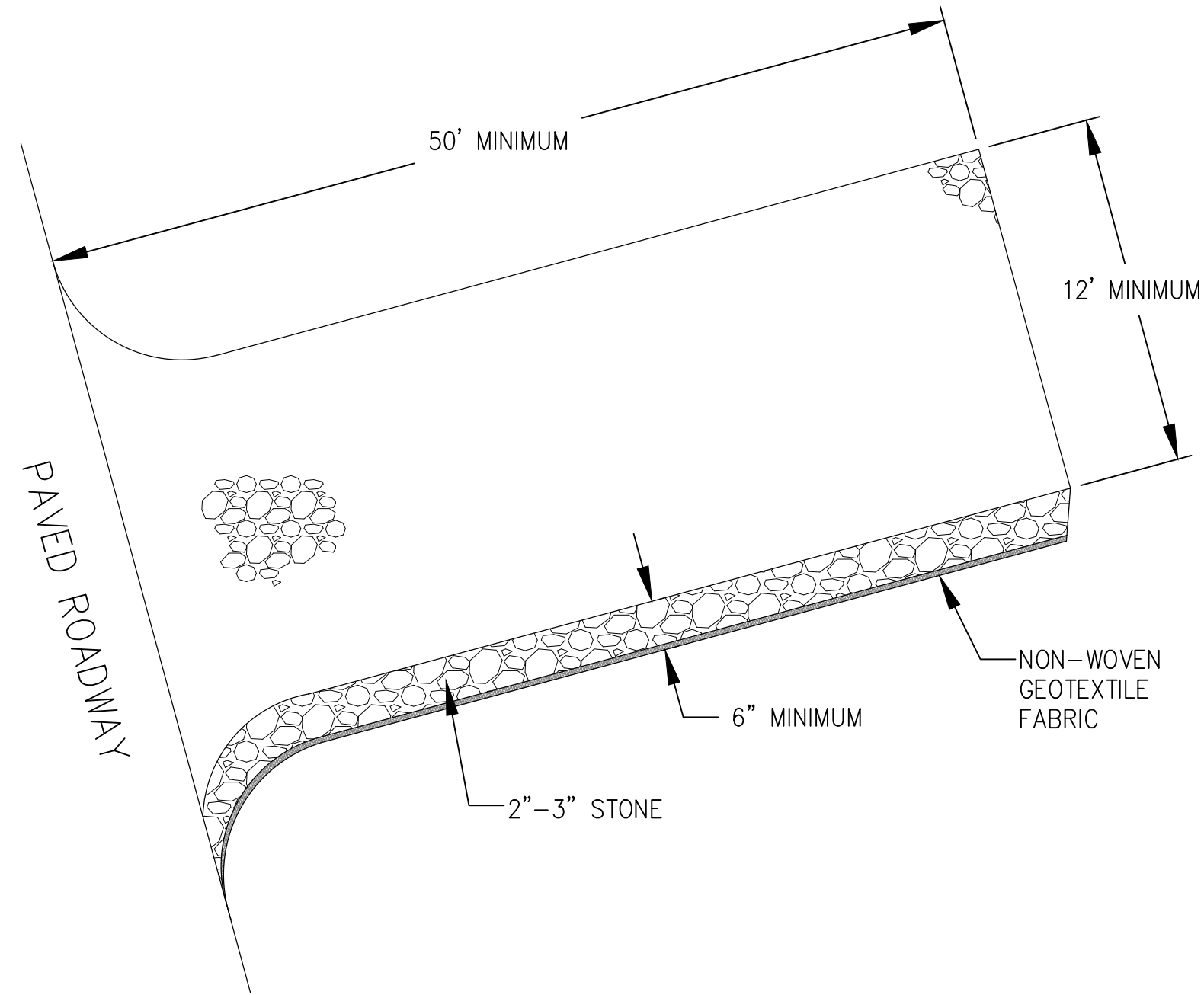

- NOTES:
- PAVED ROADWAY TO BE KEPT CLEAN OF MUD, DIRT, ROCKS, AND DEBRIS AT ALL TIMES.
 - GEOTEXTILE FABRIC SHALL COMPLY WITH CDOT 712.08b.
 - 2"-3" STONE SHALL CONTAIN LESS THAN 10% FINES.
 - CONSTRUCTION EXIT SHALL BE MAINTAINED AT ALL TIMES. STONE SHOULD BE BLADED AND/OR ADDITIONAL 2"-3" STONE SHOULD BE PLACED IF VOIDS BEGIN FILLING WITH DEBRIS.
 - IF A DRAINAGE DITCH EXISTS NEXT TO ROADWAY, INSTALL TEMPORARY CULVERT UNDERNEATH STONE CONSTRUCTION EXIT TO CONVEY FLOW.
 - PROVIDE INLET PROTECTION FOR ANY INLETS LOCATED IMMEDIATELY ADJACENT TO THE CONSTRUCTION EXIT.
 - IF TRACKOUT DOES OCCUR, ROADWAY SHOULD BE SWEEPED IMMEDIATELY.
 - RECYCLED CONCRETE OR RECYCLED ASPHALT SHALL NOT BE USED.

5 VEHICLE TRACKING PAD
DETAIL NTS

NORTH OVERFLOW CHANNEL BMP TYPICAL DETAILS



S2O Design and Engineering

Scott Shipley, P.E.
318 McConnell Drive
Lyons CO, 80540,
USA
(303) 819-3985

Client:
TOWN OF LYONS



Project Name:
BOHN PARK NORTHERN OVERFLOW

Status:
CONSTRUCTION DRAWINGS

Drawing Name:
**NORTH OVERFLOW CHANNEL TYPICAL
BMP**

Revisions:
--

Drawn By:
NW, CC

Checked By:
Scott Shipley

Date:
03/01/2017

Stamp:

REUSE OF DOCUMENT:
THIS DOCUMENT IS THE PROPERTY OF S2O DESIGN AND ENGINEERING. THE IDEAS, DESIGN AND CONTENT INCORPORATED ON THIS DOCUMENT IS AN INSTRUMENT OF PROFESSIONAL SERVICE AND SHALL NOT BE USED FOR ANY OTHER PROJECT WITHOUT THE WRITTEN AUTHORIZATION OF S2O DESIGN AND ENGINEERING.

Scale: Sheet:
SR-6.03